

This manual covers both non-disc and disc Rear Racks. Please see specific information in this manual for each type of Rear Rack.

### NON-DISC MOUNTS

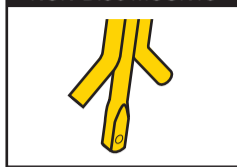

### DISC MOUNTS

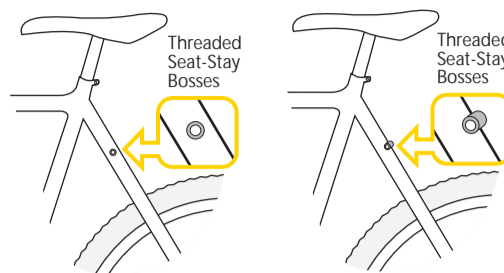
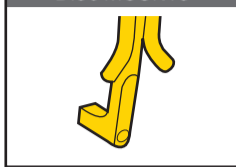

This rear carrier is designed to fit bicycles with threaded seat-stay bosses. The mounting bracket arms are designed to fit a wide range of bicycles sized from 26" wheel x 14.5" frame to 700C wheel x 63 cm frame.

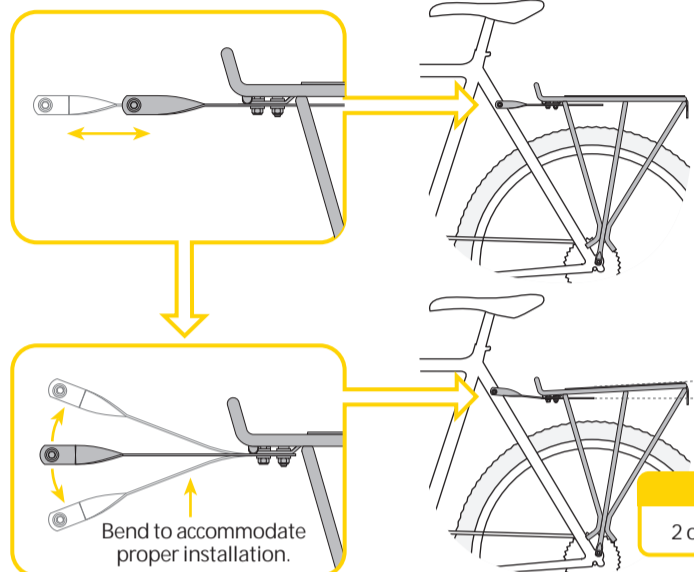

1. Attach the mounting bracket arms to the front of your One Fits All REAR RACK as shown. Don't tighten completely at this time.
2. Adjust the length and angle of the mounting bracket arms to a proper position for your bike. Adjust rear carrier to your desired angle, and tighten all the screws and nuts. (recommended 2 or 3 degrees from horizontal).

**Recommended**  
2 or 3° from horizontal

Note: If you have a small frame bike and cannot install the rack in recommended position (2 or 3° from horizontal), please purchase the extra long mounting bracket arm (34.5 cm) for proper installation.

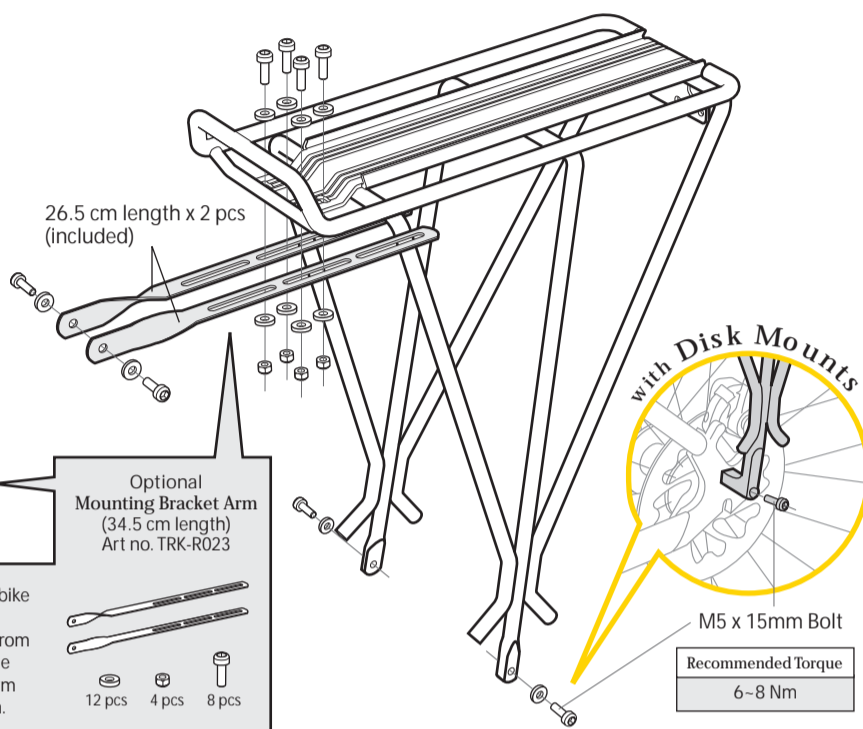

### INSTALL TAIL LIGHT MOUNT ON TUBULAR RACK

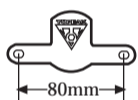

Tail Light Mount is used for mounting rear lights with 80mm (center to center) mounting holes on the Topeak Tubular Rack or MTX BeamRack.

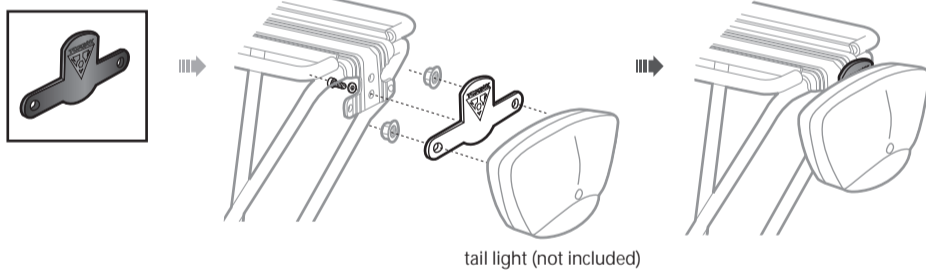

### INSTALL REDLITE MOUNT ON TUBULAR RACK

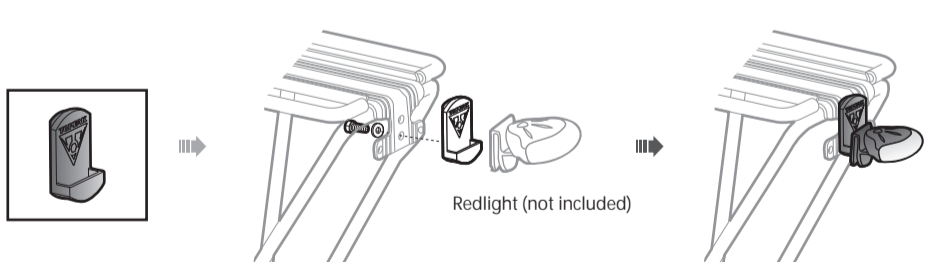

### OPTIONAL ACCESSORIES

sold separately

RedLite Mount

Tail Light Mount

RedLite UFO

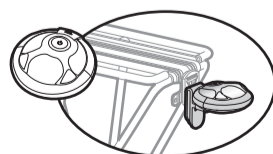
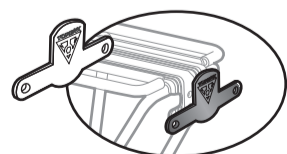
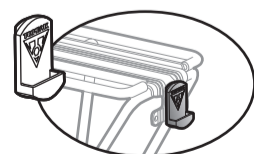

RedLite II

Mounting Bracket Arm (34.5 cm length)

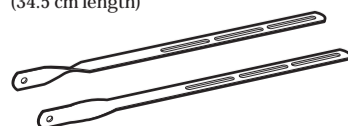
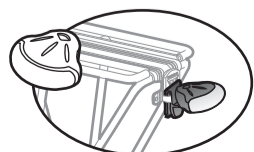

### REARRACK WITH SIDE BARS

Super Tourist DX  
Super Tourist DX with Disc Mount

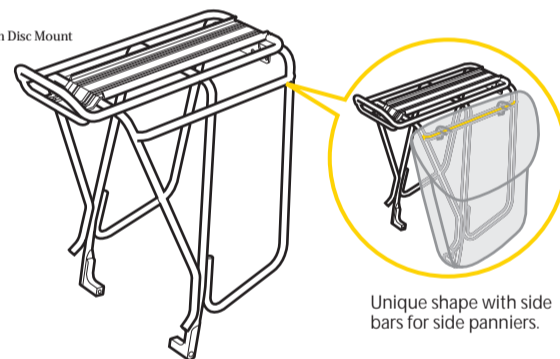

### WARNING



1. When installing Rear Rack, check that the bolts will not interfere with the brake caliper, chain, or cog set before completely tightening them. Tighten all bolts to 6-8 Nm (53-69 in-lbs) before loading Rear Rack.
2. Never exceed maximum loading capacity of 55 lbs (25 kgs).
3. Do not attempt to use Rear Rack as a passenger seat or a child carrier.
4. Rear Rack is not designed to tow any kind of trailer. Never attach a trailer to Rear Rack.
5. Before each ride, insure Rear Rack is properly attached to your frame and there are no loose straps on trunk bag, cargo bag or basket that may interfere with the rear wheel.
6. Loading Rear Rack may affect the stability and alter the riding characteristics of the bicycle, particularly regarding steering and braking.
7. If you mount a trunk bag, cargo bag, or basket, make sure the rearward view of the rear reflector or tail light is not blocked.
8. Do not make any modifications to Rear Rack.

### WARRANTY

2-year Warranty: All mechanical components against manufacturer defects only.

#### Warranty Claim Requirements

To obtain warranty service, you must have your original sales receipt. Items returned without a sales receipt will assume that the warranty begins on the date of manufacture. All warranties will be void if the product is damaged due to user crash, abuse, system alteration, modification, or used in any way not intended as described in this manual.

\* The specifications and design are subject to change without notice.

Please contact your Topeak dealer with any questions.  
For USA customer service call: 1-800-250-3068  
www.topeak.com